

Built in 1923.
 Additions in 1960, 1969, 1989.

Building size: 374,913 Square feet
 Site Size: 15 Acres
 Last Renovations: All crafts in 2003
 Auditorium Capacity: 1070
 Gym Capacity:
 Lower Bleachers: 1274
 Upper Bleachers: 1350

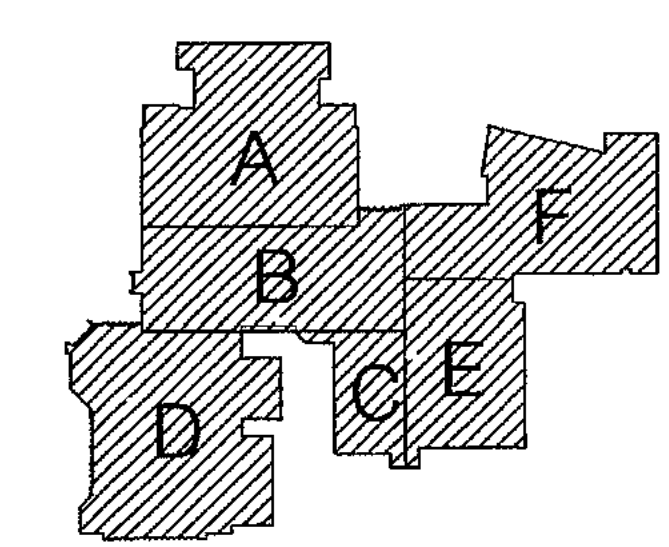

FIRST FLOOR PLAN

SCALE: 1" = 20'-0"



Architect, Engineer
**BROWNING
 DAY MULLINS
 DIERDORF
 ARCHITECTS**
 Architecture
 Landscape Architecture
 Planning

Browning Day Mullins Stewart, Inc.
 234 North Senate Avenue
 Indianapolis, Indiana 46204
 317.555.5020
 Fax: 317.555.5400



Revisions

Date Drawn Checked
 6-27-03

100 % CONSTRUCTION DOCUMENTS
 BROAD RIPPLE HIGH SCHOOL - DESIGN PACKAGE 2
 1115 BROAD RIPPLE AVE.
 INDIANAPOLIS, IN 46220

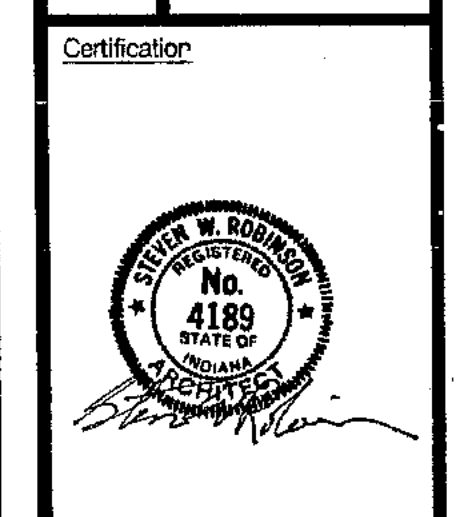

Sheet Number
 A1.01

Project Number
 02022

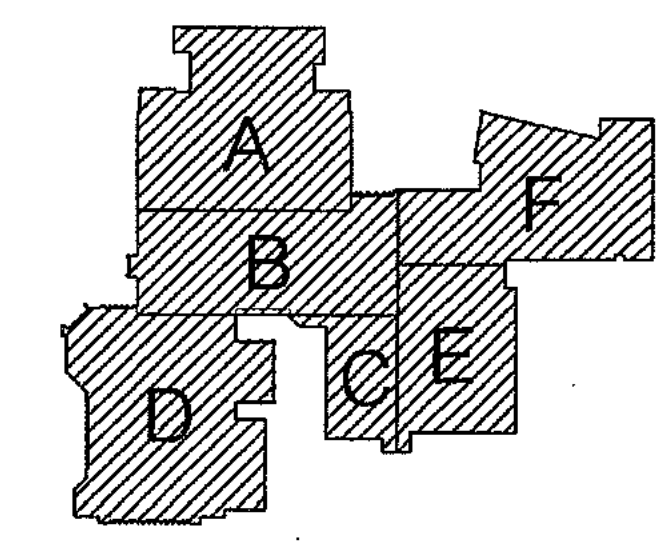
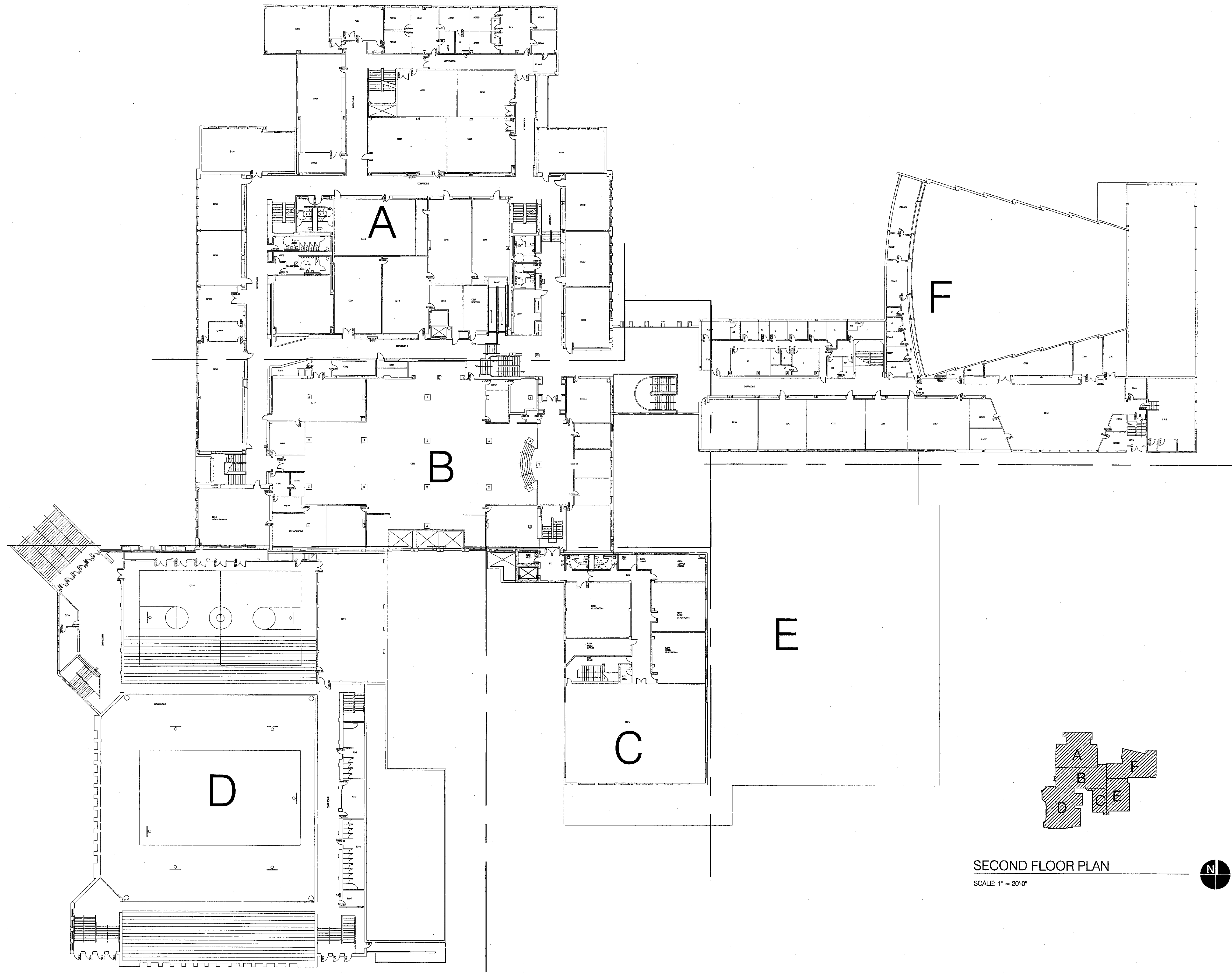

SECOND FLOOR PLAN

SCALE: 1" = 20'-0"



Architect, Engineer
**BROWNING
 DAY MULLINS
 DIERDORF
 ARCHITECTS**
 Architecture
 Landscape Architecture
 Planning

Browning Day Mullins Dierdorf, Inc.
 234 West Seneca Avenue
 Indianapolis, Indiana 46204
 317.633.2000
 Fax: 317.633.1400



Revisions

Date Drawn Checked
 6-27-03

100 % CONSTRUCTION DOCUMENTS
 BROAD RIPPLE HIGH SCHOOL - DESIGN PACKAGE 2
 1115 BROAD RIPPLE AVE.
 INDIANAPOLIS, IN 46220

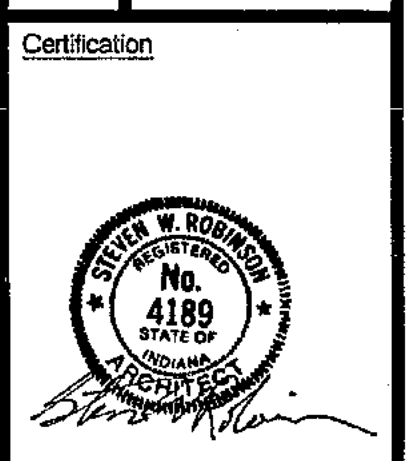

Sheet Number
 A1.02

Project Number
 02022

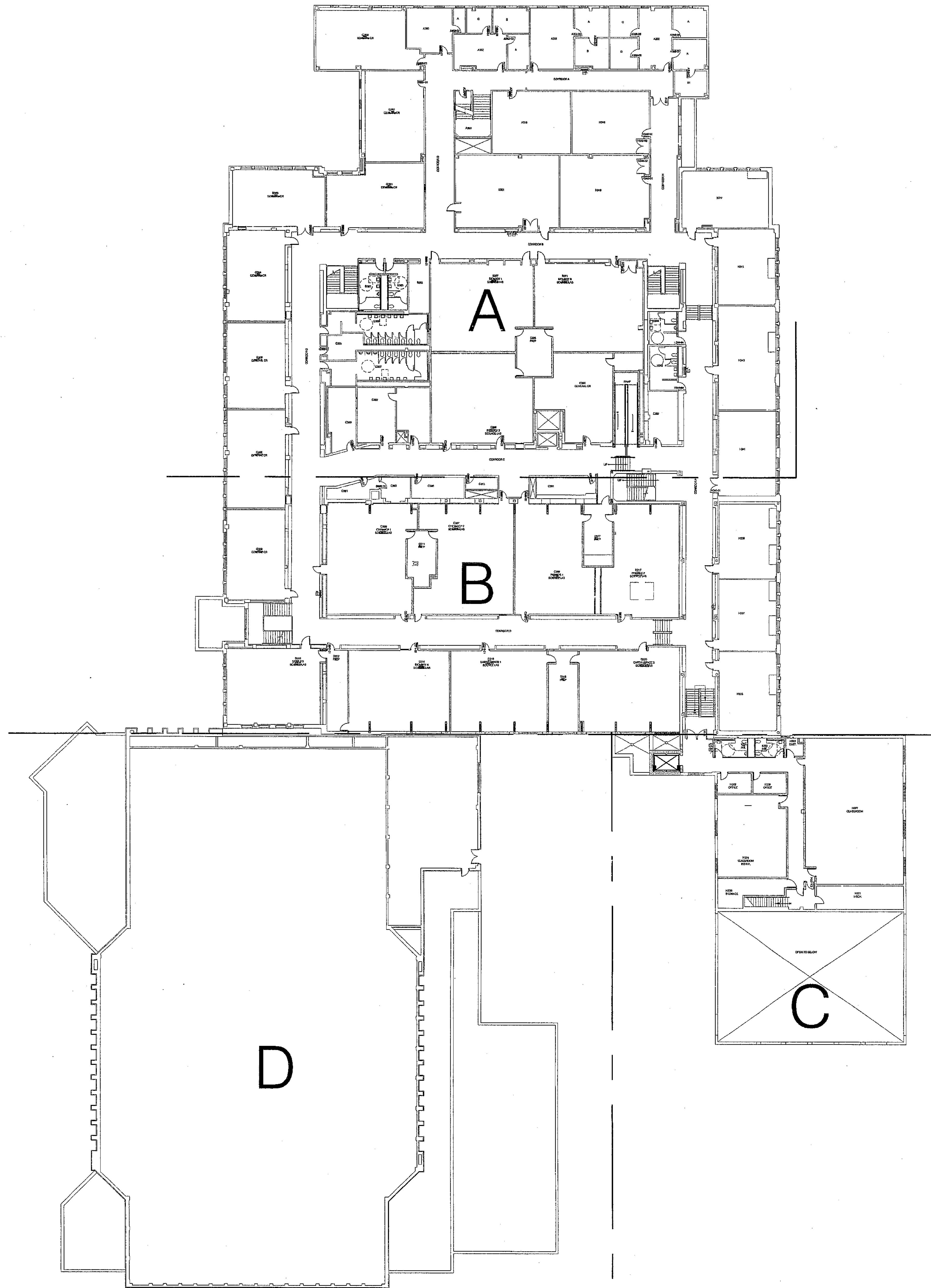

THIRD FLOOR PLAN

SCALE: 1" = 20'-0"

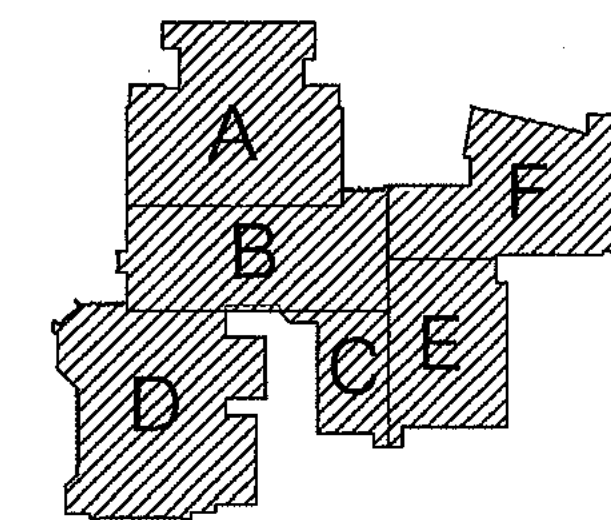

Architect, Engineer
**BROWNING
 DAY MULLINS
 DIERDORF
 ARCHITECTS**
 Architecture
 Landscape Architecture
 Planning

Browning Day Mullins Dierdorf, Inc.
 234 North Senate Avenue
 Indianapolis, Indiana 46204
 317-432-5020
 Fax: 317-432-5008



Revisions

Date Drawn Checked
 6-27-03

100 % CONSTRUCTION DOCUMENTS
 BROAD RIPPLE HIGH SCHOOL - DESIGN PACKAGE 2
 1115 BROAD RIPPLE AVE.
 INDIANAPOLIS, IN 46220

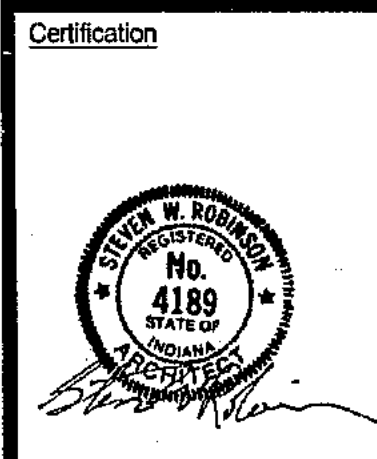

Sheet Number
 A1.03

Project Number
 02022

